



W  
WHITES

103 Exeter Street, Salisbury, Wiltshire, SP1 2SF

£259,950 Freehold

## About The Property

A charming Grade II Listed townhouse over three floors, believed to date back to the 16th century with character features including exposed wooden timbers and fireplaces. It is situated in the heart of the city centre, within easy walking distance of all it's facilities and the railway station and is offered with no onward chain.

On the ground floor there is an open plan feeling with the sitting room to the front with fireplace, oak flooring and ceiling beams. This leads through to the kitchen/diner with a good range of worktops and units with stairs to the first floor and a door to the garden. This has oak flooring and more timbers. On the first floor there is the main bedroom with fireplace together with en-suite shower room and separate bathroom. There are a further two bedrooms on the top floor both with exposed timbers. There is electric heating throughout and views of the cathedral spire.

The rear garden is enclosed by timber fencing with a decked sitting area leading to paved pathway and gravel for ease of maintenance. A pedestrian gate then leads through to the rear car parking area. Two permits are available for local parking if required.



3



2



1



826.20 sq ft

- Period Townhouse
- City Centre
- Garden
- Character Features
- Three Bedrooms
- Open Plan Reception/Kitchen
- Bathroom and Shower Room
- Electric Heating
- No Onward Chain

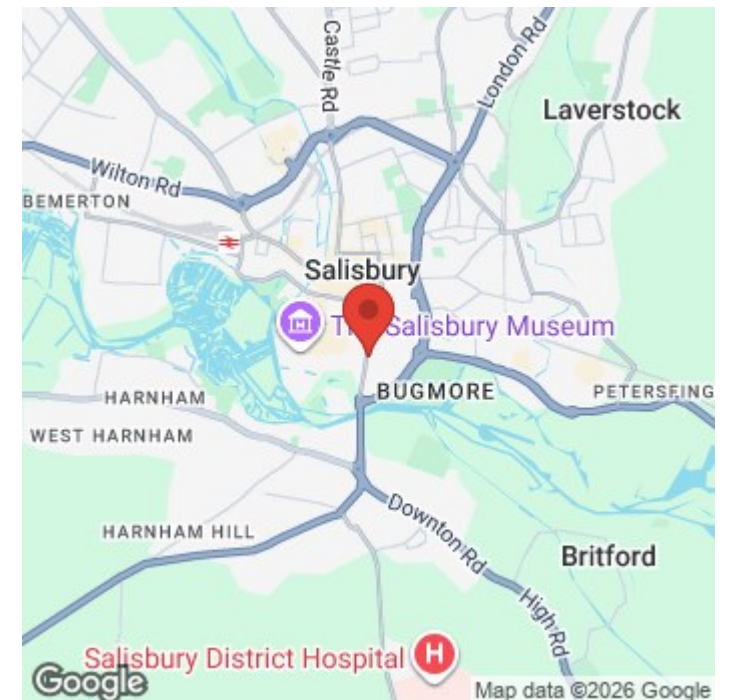



## Further Information

Local authority: Wiltshire Council

Council Tax: C - £2350.54 (2025/2026)

Tenure: Freehold

Services: Mains electricity, water and drainage.

Heating: Electric heating.

Directions: From our offices in Castle Street proceed south and bear left into Blue Boar Row, then right into Brown Street. Proceed through the traffic lights and bear right into St Ann Street and left into Exeter Street. No. 103 will be found on the left hand side after a short distance.

What3words: [///social.solved.tiny](https://www.what3words.com/#!/social.solved.tiny)

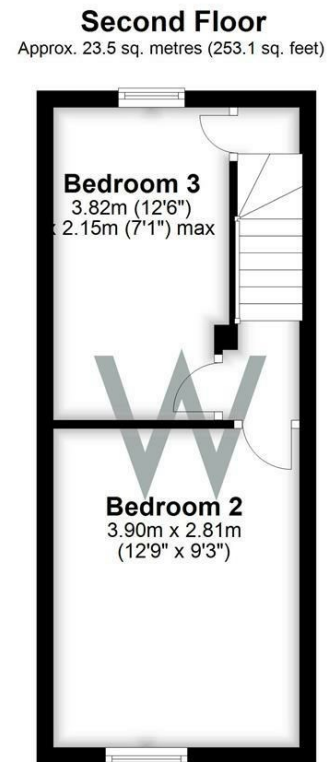
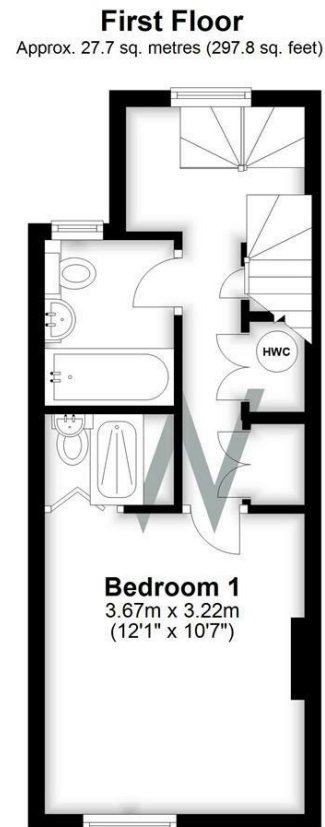
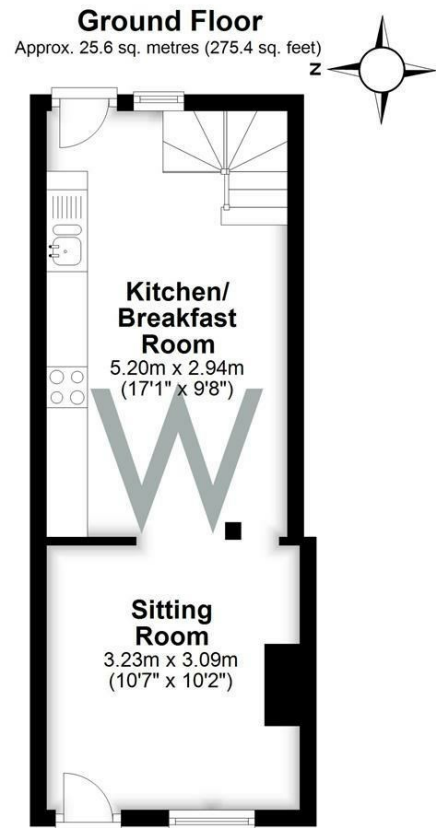

Total area: approx. 76.8 sq. metres (826.2 sq. feet)